



# VAC-CON

MORE **POWER** TO YOU

3.5 YARD V-230  
COMBINATION MACHINE



VAC-CON POWER  
AND QUALITY  
IN A SMALLER,  
MORE ECONOMICAL  
PACKAGE

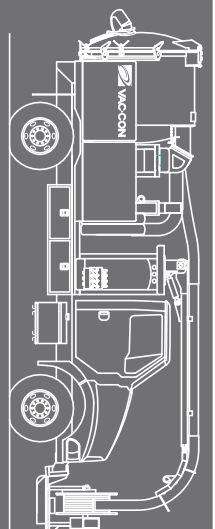

# 3.5 YARD V-230 COMBINATION MACHINE

## MINIMUM CHASSIS REQUIREMENTS

|                                  |
|----------------------------------|
| 210 HP Diesel Engine             |
| Manual or Automatic Transmission |
| 10,000 lb. Capacity Front Axle   |
| 17,500 lb. Capacity Rear Axle    |
| 108" Cab to Axle (CA) Dimension  |
| Clean Frame Rails (back of cab)  |
| 50 Gal. Fuel Tank                |

## DEBRIS TANK

**Capacity:** 3.5 Cubic Yards (2.68 Cubic Meters)  
**Material:** 3/16" Corten Steel w/ 5 yr Warranty  
**Rear Door:** Full Opening  
**Dump:** 50° Angle  
**Drain:** 5" Butterfly Valve with 10' Lay Flat Hose  
**Shut Off:** Stainless Steel Float Balls

## VACUUM COMPRESSOR

2-Stage Centrifugal Compressor w/ 5 yr Warranty  
**Rating:** 135" Negative Water and 0-8000 CFM  
**Filtration:** Centrifugal Separator with Clean Out  
**Power Source:** Hydrostatic Drive / Chassis Engine

## WATER TANK

**Construction:** Cross-Linked Polyethylene Non-Corrosive Tank w/ 10 yr Warranty  
**Tank Thickness:** 3/8" (9.53 mm)  
**Hydrant Fill Hose Diameter:** 2-1/2" (63.5 mm)  
**Hydrant Fill Hose Length:** 25' (7.62 m)  
**Additional Features:** Water Level Sight Gauge, Tank Access Inspection Ports  
**Capacity:** 500 gallons

## WATER PUMP

**Style:** Triplex  
**Rated For:** 40 gpm at 3000 psi (113.5 lpm / 210 Bar)  
**Power Source:** Hydrostatic Drive / Chassis Engine

## HOSE REEL

**Style:** 180° Manual Rotation, "Easy Tilt" for Engine Access  
**Location:** Front Mounted  
**Capacity:** Up to 600' x 3/4" (182.9 m x 19 mm) Hose, Up to 1200' x 1/2" (304.8 m x 12.7 mm) Hose, Up to 800' x 5/8" Hose  
**Controls:** Pump On / Off, Vacuum On / Off, Hose Reel In / Out, Hose Reel Speed Control, Engine Throttle, Boom Joystick, Pendant Control  
**Gauges:** Water System Pressure Gauge, Tachometer

## HAND GUN WATER SYSTEM

25 ft. (7.62 m) of 1/2" (12.7 mm) High-Pressure Hose  
 20 gpm (75.7 lpm) at 600 psi (41 Bar)

## BASIC MACHINE SPECIFICATIONS

|   |                               |               |
|---|-------------------------------|---------------|
| Debris Tank Capacity                      | 3.5 Cu. Yd.                   | 2.68 Cu. Mtr. |
| Water Tank Capacity                       | 500 Gal.                      | 1892 L        |
| Overall Length OAL (approx.)              | 28'                           | 8.73 m        |
| Overall Width OAW (approx.)               | 8'                            | 2.43 m        |
| Overall Height Above Ground OAH (approx.) | 10'6"                         | 3.12 m        |
| Vacuum System Drive                       | Hydrostatic                   |               |
| Water System Drive                        | Hydrostatic                   |               |
| Sewer Hose                                | 400' x 3/4" (121.9 m x 19 mm) |               |

## BOOM

- Fully Hydraulic Extendable 5' with 180° Gear Rotation
- Dual Lift Cylinders
- 20.5' of 6" Aluminum Pipe & Clamps

## NOZZLES & ACCESSORIES

- Penetrator Nozzle
- Sanitary Nozzle
- Hose Guide with Retaining Rope
- Hydrant Wrench
- Leader Hose
- Nozzle Pipe Extension

## TOOL STORAGE

- Tool Box (16" x 13" x 72")
- Vertical Pipe Storage

## OPTIONS

- Hydro-Excavation System
- Winter Recirculating System
- Air Purge (Requires Air Brakes)
- Hose Footage Counter
- Arrowboard / Arrowstick
- Revolving / Strobe Lights
- Hydraulic Door Locks
- Debris Tank Flush Out System
- Vacuum Breaker System
- Low Water Alarm w/ Light
- 50' Retractable Hand Gun Hose Reel
- Positive Displacement Blower (2100 CFM)
- Water Pump Rated for 25 gpm at 4000 psi (94.6 lpm / 280 Bar) includes 400' x 5/8" Sewer Hose
- Boom Work Lights
- Pump-Off / 200 gpm
- Debris Tank Interconnect
- Handheld Spotlight
- Inspector Cam
- Fan Flush Out
- Wireless Remote
- Backup Alarm
- 8" dia. Inlet & Pick Up Tubes

*Complete Selection of Nozzles Available.  
 Specifications subject to change without notice.*



A HOLDEN INDUSTRIES Company

Vac-Con's 3.5 Yard Combination Machine is easy to operate, safe, durable and outperforms the competition. All backed by **Power Up** customer support, and our dedicated dealer network brings more power to you.

[www.vac-con.com](http://www.vac-con.com)



Search:  
VacConInc



Search:  
Vac-Con